

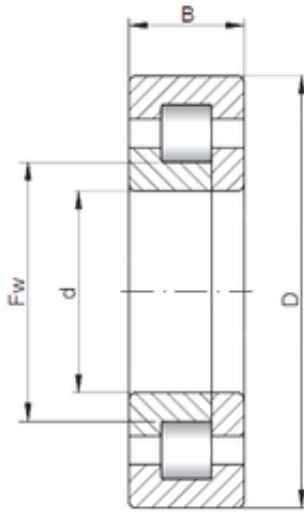

## BEARING PRECISION AXLE CORP.



670 mm x 980 mm x 180 mm ISO NUP20/670  
cylindrical roller bearings

Bearing No. NUP20/670

Size	670x980x180 mm
Bore Diameter	670 mm
Outer Diameter	980 mm
Width	180 mm
d	670 mm
D	980 mm
B	180 mm
C	180 mm

NUP20/670 Bearing 2D drawings and 3D CAD models