

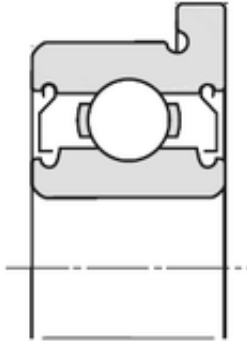

BEARING PRECISION AXLE CORP.

15,000 mm x 28,000 mm x 7,000 mm NTN
F-6902J1LLU deep groove ball bearings



Bearing No. F-6902J1LLU

Size	15x28x7 mm
Bore Diameter	15,000 mm
Outer Diameter	28,000 mm
Width	7,000 mm
d	15,000 mm
D	28,000 mm
B	7,000 mm
C	7,000 mm

F-6902J1LLU Bearing 2D drawings and 3D CAD models