

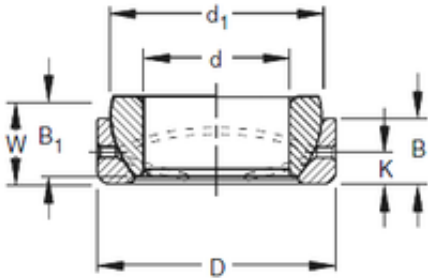

BEARING PRECISION AXLE CORP.

Timken 12SBT20 plain bearings



Bearing No. 12SBT20

Size	31.75x50.8x13.97 mm
Bore Diameter	31.75 mm
Outer Diameter	50,8 mm
Width	13,97 mm
d	31.75 mm
D	50,8 mm
B1	17,78 mm
C	13,97 mm
d1	18,8 mm

12SBT20 Bearing 2D drawings and 3D CAD models